

1 2 3 4 5 6 7 8

H H

G G

F F

E E

D D

C C

B B

A A

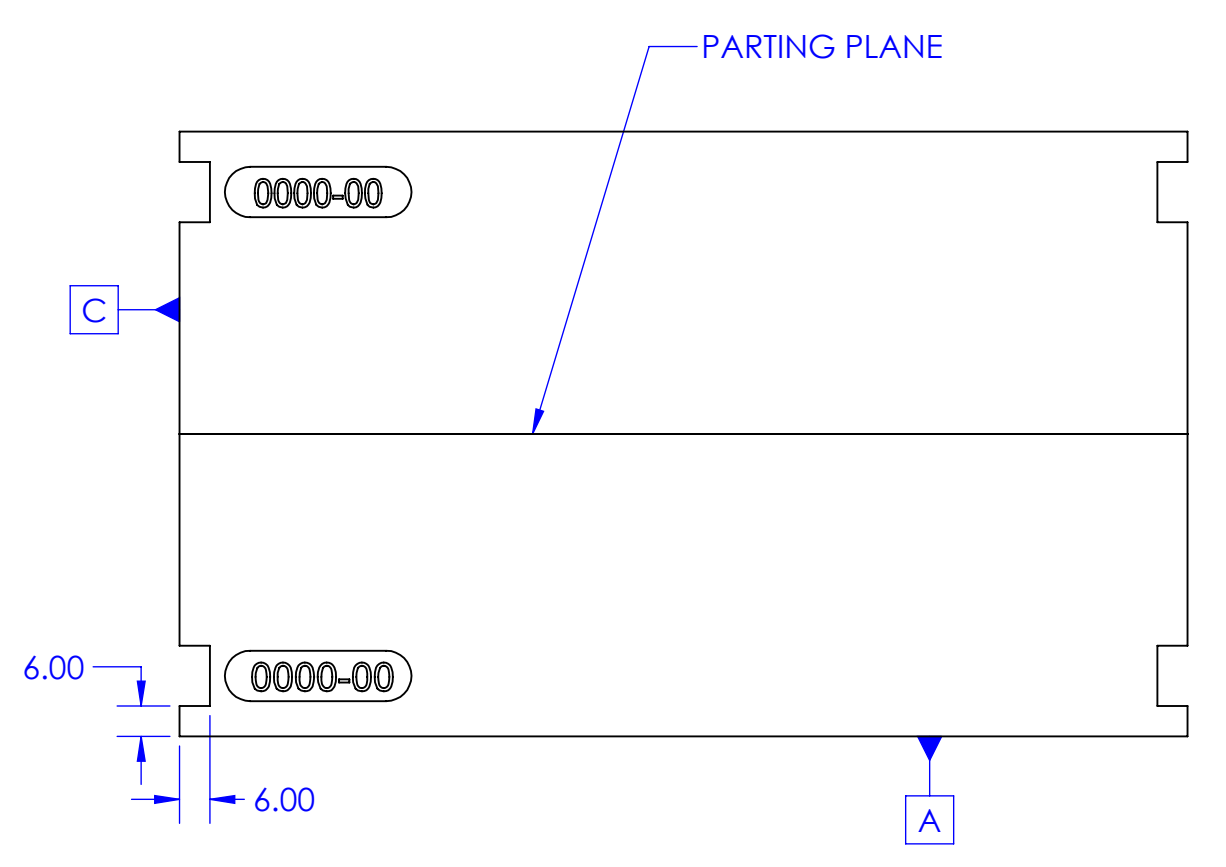
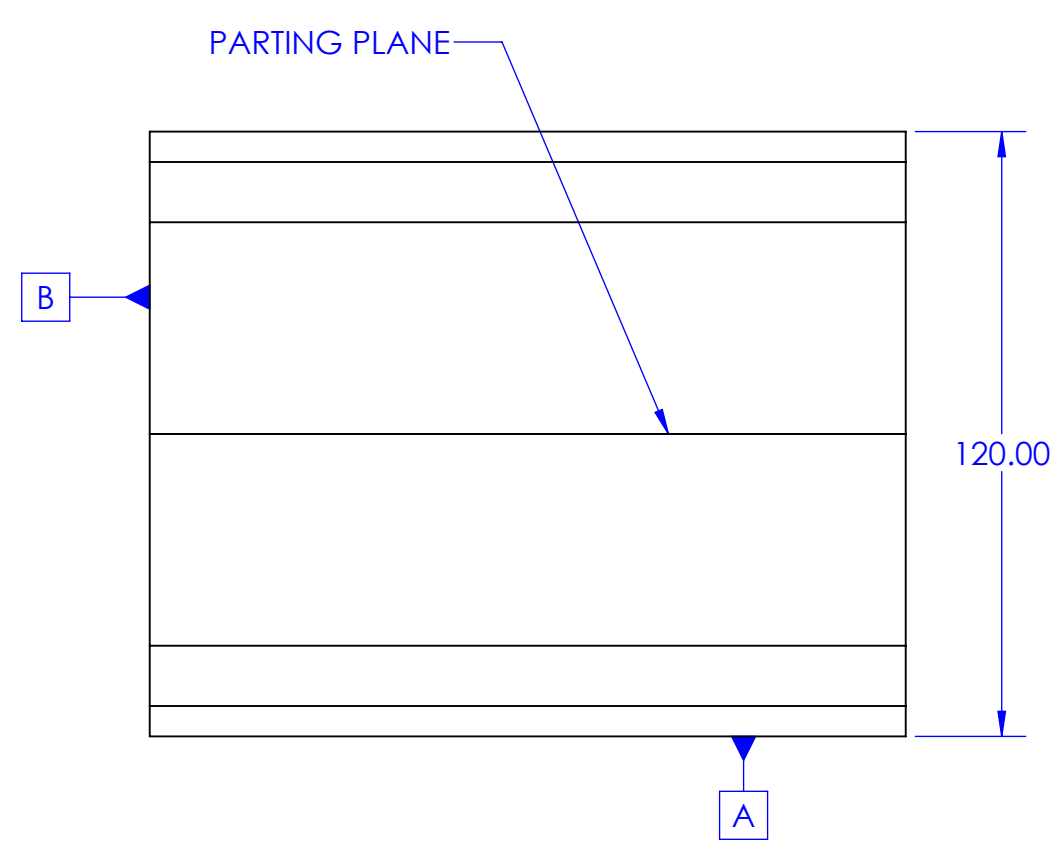
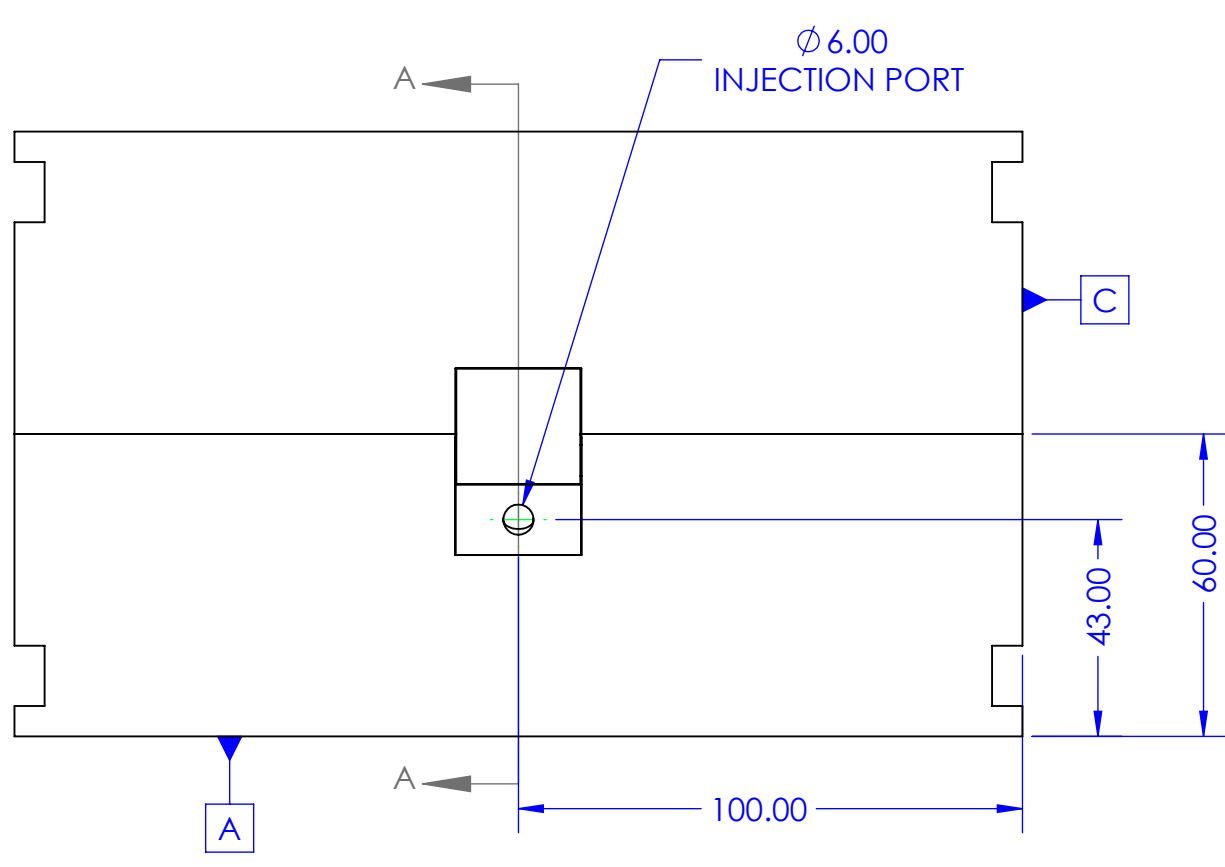
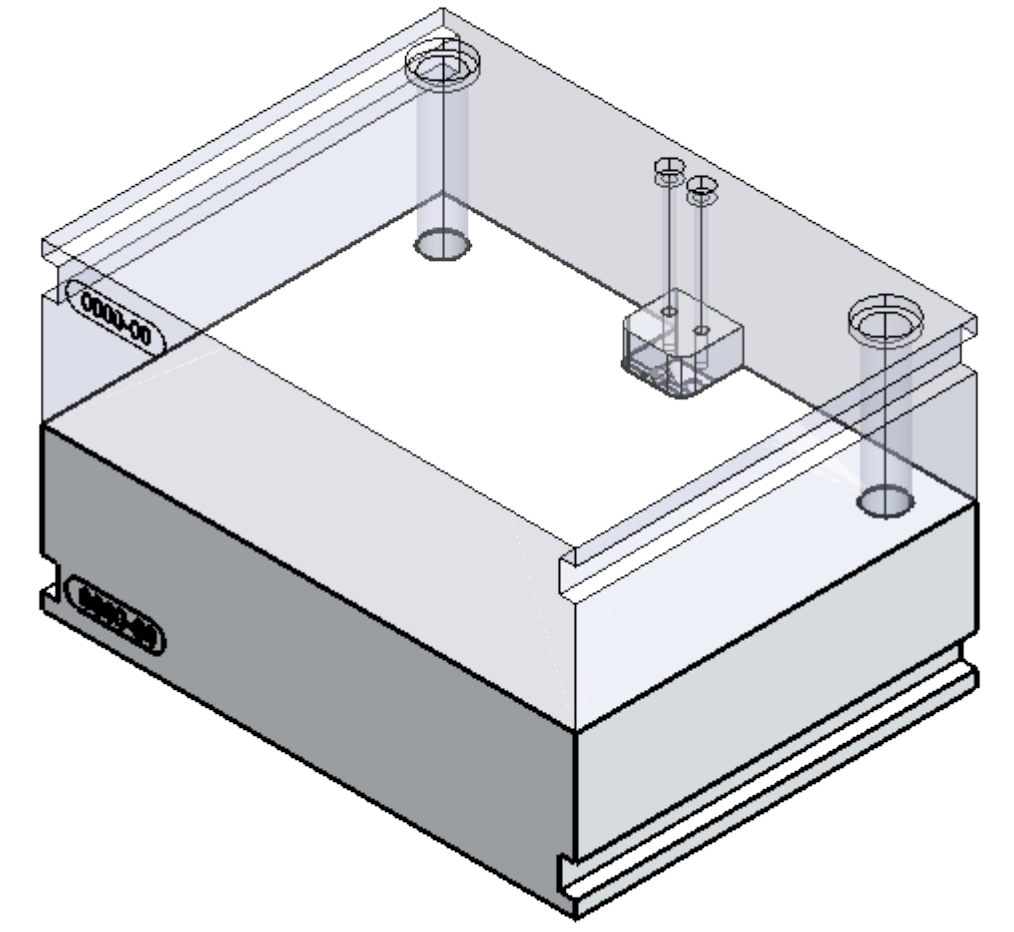
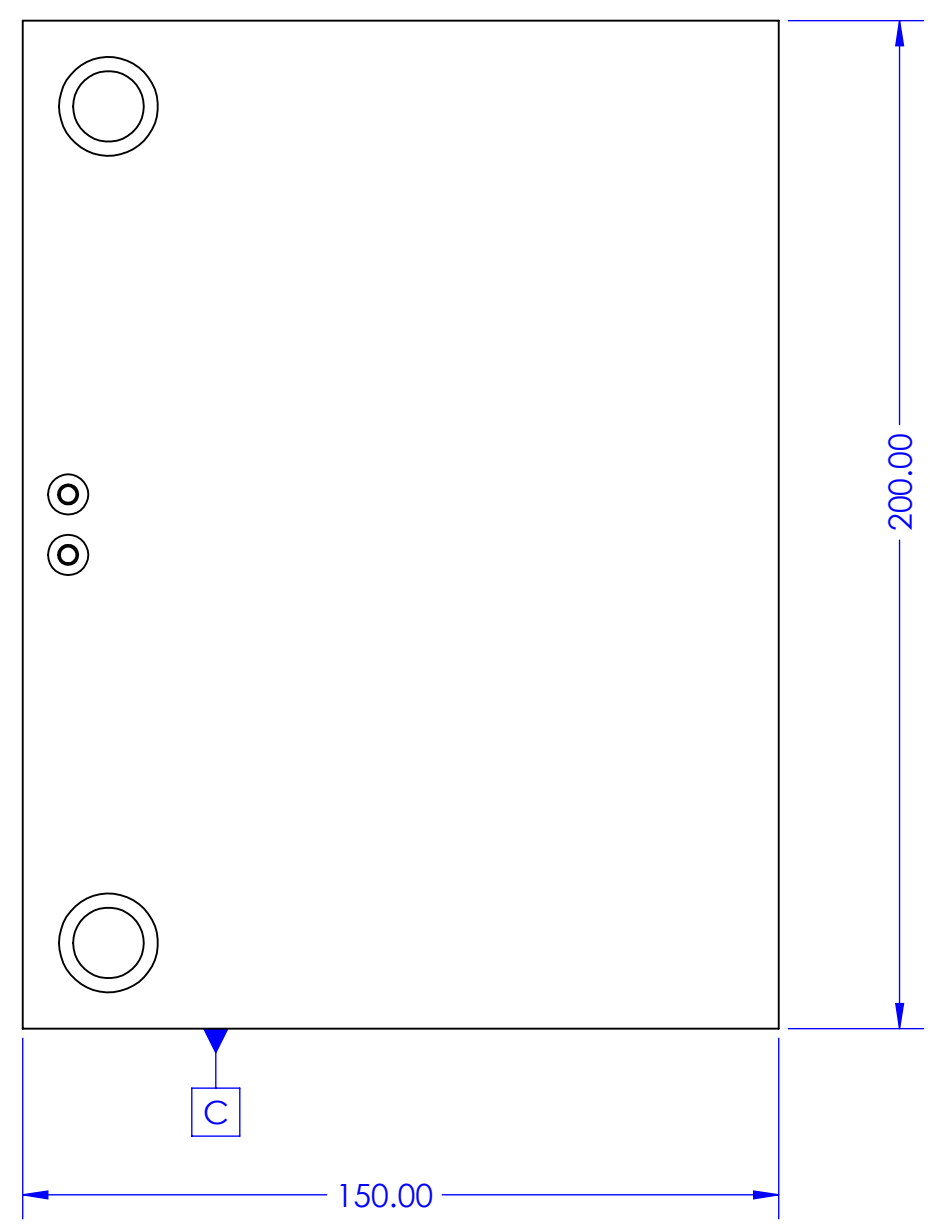
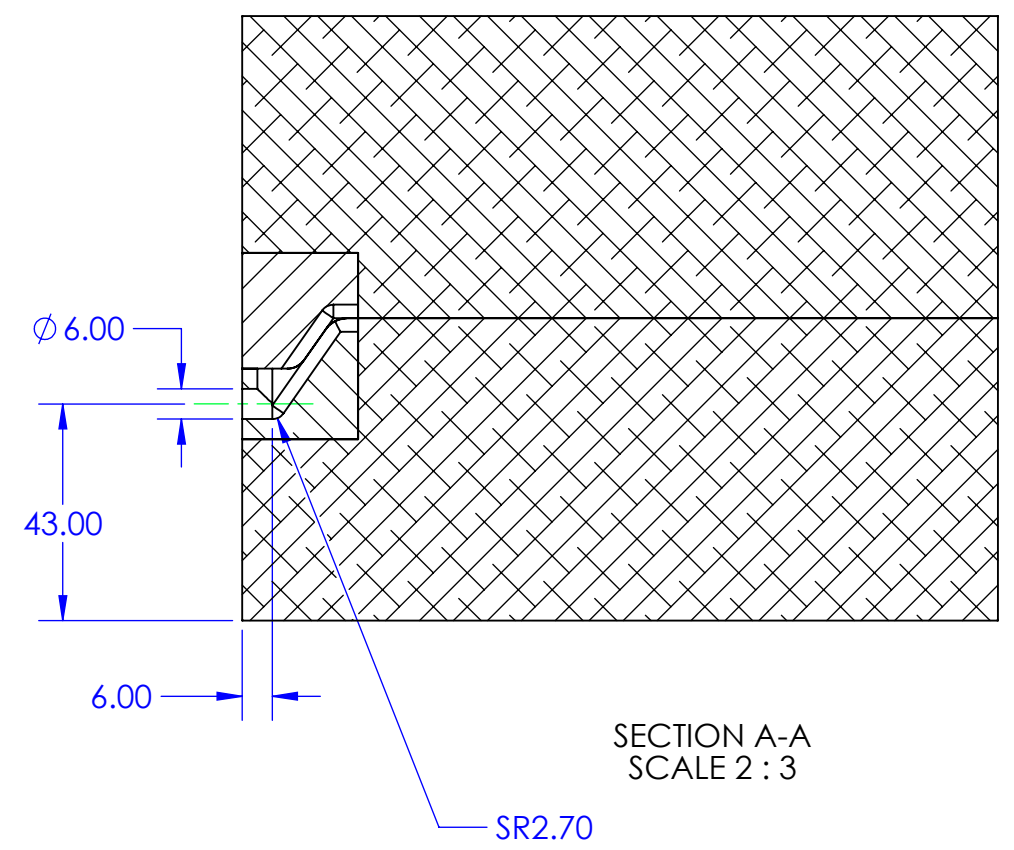

- NOTES:
- 1) BASE MAT'L: 7075-T6 ALUM
 - 2) INJECTION NOZZLE INSERTS TO BE TOOL STEEL
 - 3) 150x200x60 MOLD BASE FOR MM8000

Proprietary Notice: This drawing and the information contained herein is the property of Moldman Systems and may not be reproduced or used for other purposes than authorized by Moldman Systems.

UNLESS OTHERWISE SPECIFIED DIMENSIONS ARE IN MM. TOLERANCES ARE:		CAD GENERATED DRAWING : DO NOT MANUALLY UPDATE		MOLDMAN SYSTEMS 4649 Aircenter Dr. Ste 101, Reno, NV 89521 (775) 332-1600 fax: (775) 332-1601	
DECIMALS:	ANGLES:	DO NOT SCALE DRAWING		TITLE: MM8000, 150x200x60 Mold Blank PART NUMBER	
.X : +/- 0.3	X : +/- 0.5°	APPROVALS		DATE	SIZE
.XX : +/- 0.13	X.X : +/- 0.1°	CREATED CB		02/02/18	DRAWING SCALE: n/a
MATERIAL: SEE NOTES		CHECKED		REV.	01
FINISH: SEE NOTES		C		SHEET 1 OF 1	

1 2 3 4 5 6 7 8