

NOTES - UNLESS OTHERWISE SPECIFIED:

- 1. MATERIAL: HIGH DENSITY POLYETHYLENE (HDPE)
- 2. DIMENSIONS IN mm (INCHES)
- 3. APPEARANCE: GREEN IN COLOR
- 4. FINISH: CLEAN & FREE OF MOLDING FLASH

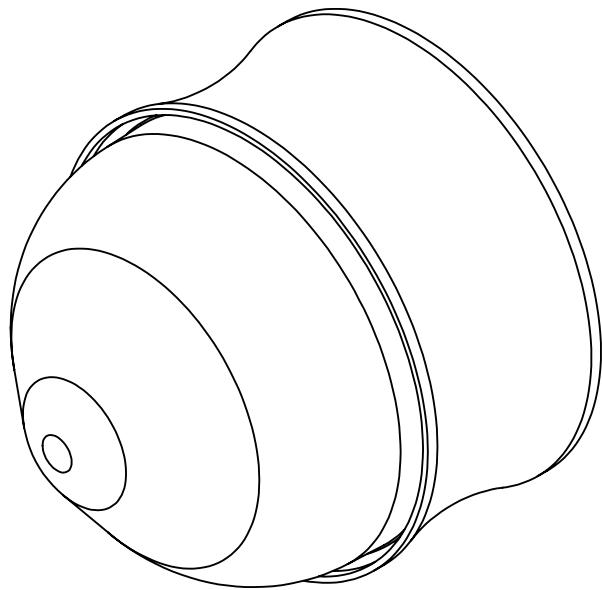
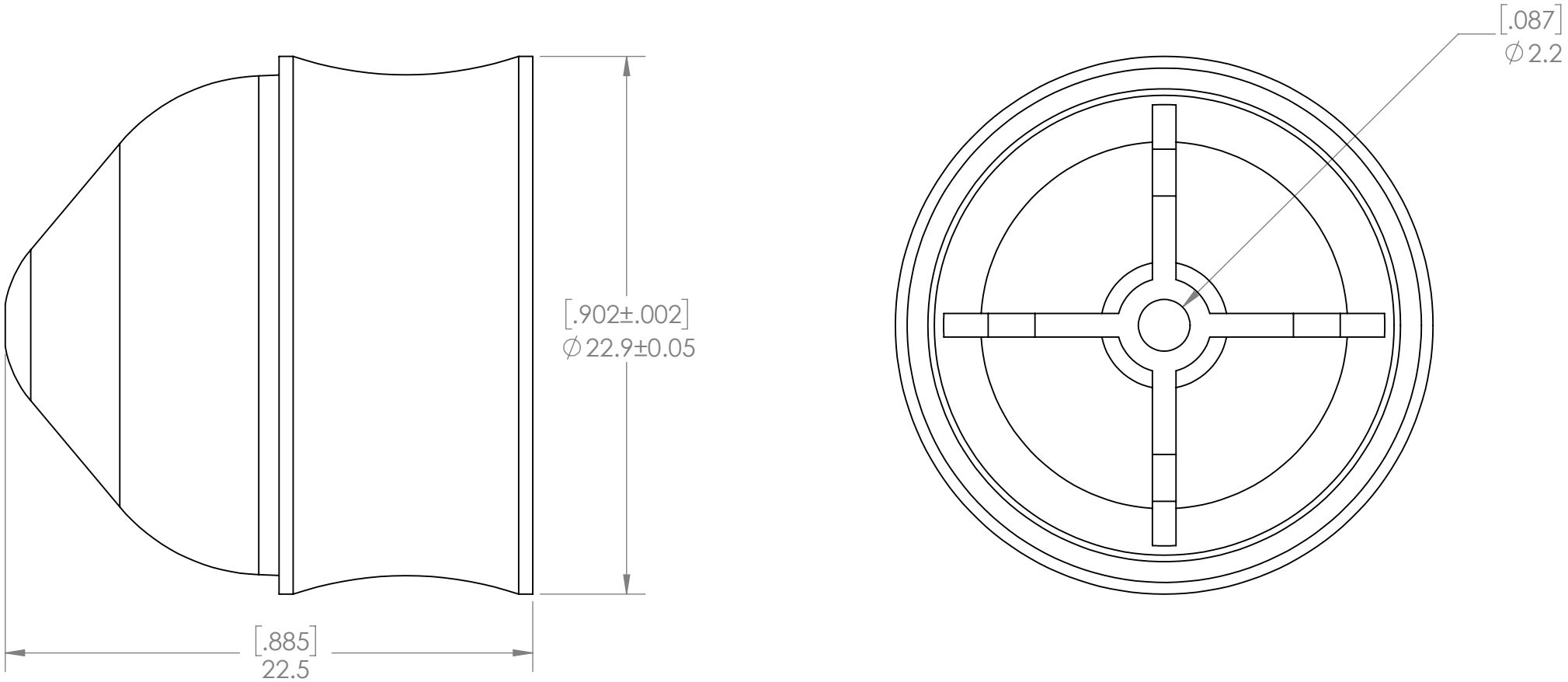

PROPRIETARY AND CONFIDENTIAL
THE INFORMATION CONTAINED IN THIS
DRAWING IS THE SOLE PROPERTY OF
FISNAR. ANY REPRODUCTION IN PART OR
AS A WHOLE WITHOUT THE WRITTEN
PERMISSION OF FISNAR IS PROHIBITED.

PRODUCT:	QUANTX
END ITEM:	
NEXT ASSY:	
SIMILAR TO:	
APPLICATION	

UNLESS OTHERWISE SPECIFIED: DIMENSIONS ARE IN MILLIMETERS TOLERANCES: ANGULAR: MACH ± 1/2 ONE PLACE DECIMAL ±.25 TWO PLACE DECIMAL ±.13 BREAK EDGES .15/.25
INTERPRET GEOMETRIC TOLERANCING PER: ANSI Y14.5M
MATERIAL HIGH DENSITY POLYETHYLENE (HDPE)
DO NOT SCALE DRAWING

APPROVED BY	CURRENT	INITIAL
DRAWN	RC	RC
CHECKED		
ENG APPR.		
MFG APPR.		
DATE	04/06/22	04/06/22
FINISH - UNLESS OTHERWISE SPECIFIED:		
TOL < ± .2	TOL ≥ ± .2	
1.6	3.2	

		
TITLE: QUANTX SMOOTHFLOW 30/55CC PISTON - GREEN		
SIZE B	DWG. NO. 8001009	REV 1
SCALE: 4:1	WT LBS:	SHEET 1 OF 1